

# JAM60S02

265-285 1000V Cypress Series

MONOCRYSTALLINE SILICON SOLAR MODULE



## JA Solar Holdings Co., Ltd.

JA Solar Holdings Co., Ltd. is a world leading manufacturer of high-performance solar power products that convert sunlight into electricity for residential, commercial and utility-scale power generation. The company was founded in May 2005 and publicly listed on NASDAQ in February 2007. JA Solar has been the world's leading cell producer since 2010, and has firmly established itself as a tier 1 module supplier since 2012. Capitalizing on our strength in solar cell technology, we are committed to provide modules with unparalleled conversion efficiency, yield efficiency, and reliability to enable you to maximize your returns on PV projects. With its leading industry experience, continuous effort on R&D, customer-oriented service and solid financial status, JA Solar is your best choice of long-term trustworthy partner.

Address: Building No.8, Nuode Center, Automobile Museum East Road, Fengtai District, Beijing, China

TEL: +86 (10) 63611888

FAX: +86 (10) 63611999

Email: sales@jasolar.com market@jasolar.com

## Superior Warranty

- 12-year product warranty
- 25-year linear power output warranty

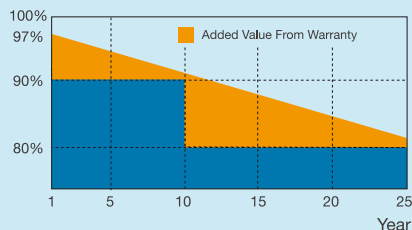

## Key Features



5BB design reduces cell series resistance and stress between cell interconnectors to improve module reliability and conversion efficiency



High power output of more than 290W and module efficiency up to 17.43 % which has been verified by TÜV Rheinland



Anti-reflective and anti-soiling surface reduces power loss from dirt and dust



Outstanding performance in low-light irradiance environments



Excellent mechanical load resistance: Certified to withstand high wind loads (2400Pa) and heavy snow loads (5400Pa)



Strong salt and ammonia resistance certified by TÜV NORD

## Reliable Quality

- Positive power tolerance: 0~+5W
- Modules binned by current to improve system performance
- Potential Induced Degradation (PID) Resistant in accordance to IEC62804

## Comprehensive Certificates

- IEC 61215, IEC 61730, UL1703, CEC Listed, MCS and CE
- ISO 9001: 2008: Quality management systems
- ISO 14001: 2004: Environmental management systems
- BS OHSAS 18001: 2007: Occupational health and safety management systems
- Environmental policy: The first solar company in China to complete Intertek's carbon footprint evaluation program and receive green leaf mark verification for our products



Specifications subject to technical changes and tests. JA Solar reserves the right of final interpretation.

# JAM60S02

## 265-285/SC

### 1000V Cypress Series

JA SOLAR

#### MECHANICAL DIAGRAMS

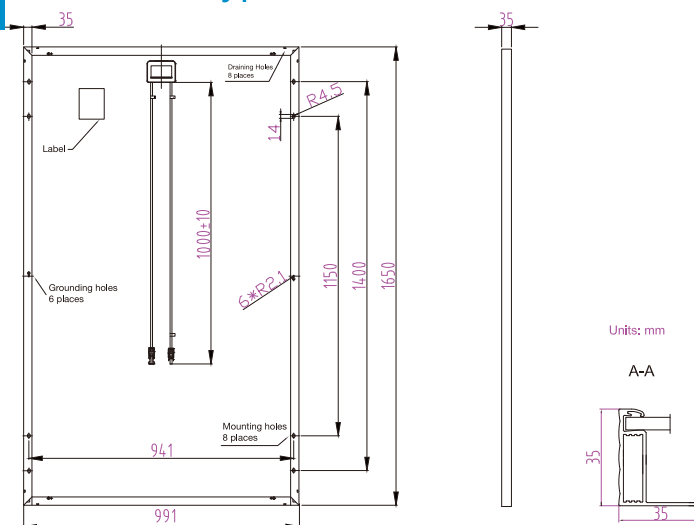
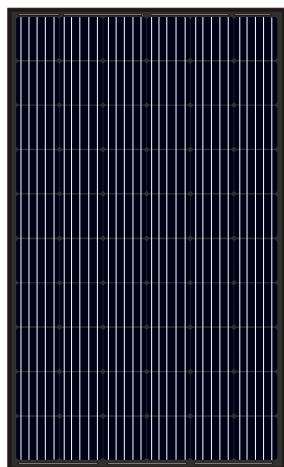

#### SPECIFICATIONS

Cell	Almost Full Square Mono 156.75x156.75mm
Weight	18.2kg±3%
Dimensions	1650x991x35mm
Cable Cross Section Size	4mm <sup>2</sup>
No. of Cells and Connections	60 (6x10)
No. of Diodes	IP67, 3 diodes
Junction Box Connector	MC4 Compatible
Packaging Configuration	30 Per Pallet

#### OPERATING CONDITIONS

Maximum System Voltage	1000V DC (IEC)
Operating Temperature	-40°C~+85°C
Maximum Series Fuse	20A
Maximum Static Load, Front Maximum Static Load, Back	5400Pa 2400Pa
NOCT	45±2°C
Application Class	Class A

#### ELECTRICAL PARAMETERS AT STC

TYPE	JAM60S02 -265/SC	JAM60S02 -270/SC	JAM60S02 -275/SC	JAM60S02 -280/SC	JAM60S02 -285/SC
Rated Maximum Power (Pmax) [W]	265	270	275	280	285
Open Circuit Voltage (Voc) [V]	38.23	38.39	38.52	38.65	38.78
Maximum Power Voltage (Vmp) [V]	30.43	30.69	30.80	30.98	31.15
Short Circuit Current (Isc) [A]	9.17	9.29	9.38	9.49	9.58
Maximum Power Current (Imp) [A]	8.71	8.80	8.93	9.04	9.15
Module Efficiency [%]	16.21	16.51	16.82	17.12	17.43
Power Tolerance	-0~+5W				
Temperature Coefficient of Isc (α <sub>Isc</sub> )	+0.059%/°C				
Temperature Coefficient of Voc (β <sub>Voc</sub> )	-0.330%/°C				
Temperature Coefficient of Pmax (γ <sub>Pmp</sub> )	-0.410%/°C				
STC	Irradiance 1000W/m <sup>2</sup> , cell temperature 25 °C, AM 1.5G				

#### CHARACTERISTICS

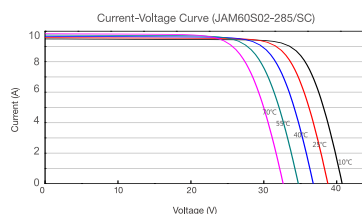
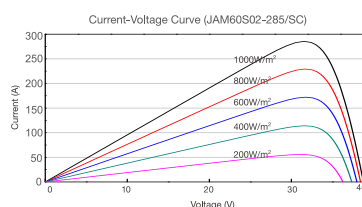
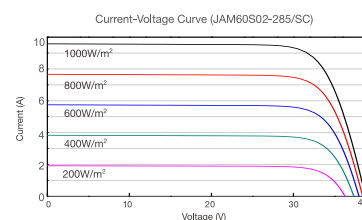

#### ELECTRICAL PARAMETERS AT NOCT

TYPE	JAM60S02 -265/SC	JAM60S02 -270/SC	JAM60S02 -275/SC	JAM60S02 -280/SC	JAM60S02 -285/SC
Max Power (Pmax) [W]	195	198	202	206	209
Open Circuit Voltage (Voc) [V]	34.94	35.20	35.50	35.77	35.97
Max Power Voltage (Vmp) [V]	28.19	28.47	28.67	28.86	29.05
Short Circuit Current (Isc) [A]	7.28	7.35	7.41	7.48	7.56
Max Power Current (Imp) [A]	6.91	6.97	7.05	7.13	7.21
NOCT	Irradiance 800W/m <sup>2</sup> , ambient temperature 20°C, wind speed 1m/s, AM 1.5G				

Electrical data in this catalog do not refer to a single module and they are not part of the offer. They only serve for comparison among different module types.