



## Znshinesolar Module Characteristics

- ◆ Up to 2400 pa — withstanding high wind loads  
Up to 5400 pa — snow loads  
Robust anodized aluminium alloy frame ensuring a stable mechanical life. The high-transparency low-iron tempered glass bearing 25mm ice-ball with velocity of 23m/s
- ◆ Anti-aging EVA
- ◆ IP65 rated junction box enhancing thermal isolation
- ◆ Flexible Size meeting clients different requirement for different systems and applications

## Advantages:

- ◆ 25 years limited power output warranty:  
90%-10 years  
80%-25 years
- ◆ Product liability insurance
- ◆ Stock warehouse in Europe
- ◆ Regional technical and sales support
- ◆ Membership in PV CYCLE — Free module recycling

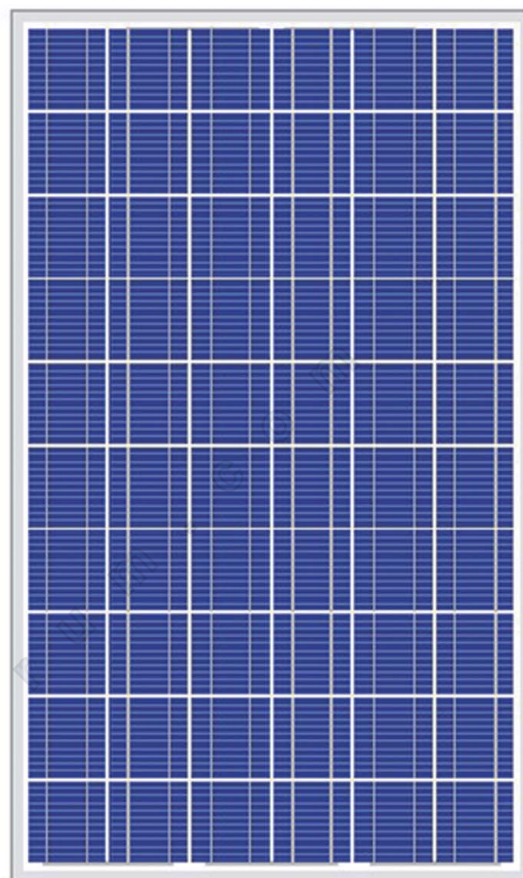

Znshinesolar is a vertically integrated leading manufacturer of solar photovoltaic modules with rigorous quality control from basic materials, producing ingots, wafers, cells & modules, supplying the products with high reliability, guaranteed quality and best services to her clients.



APPROVED PRODUCT





# Multi-crystalline solar module series

## Power range: 225-245 Watt

# ZNSHINESOLAR®

### Electrical Characteristic

Model	ZX225(30)P-A/B	ZX230(30)P-A/B	ZX235(30)P-A/B	ZX240(30)P-A/B	ZX245(30)P-A/B
Maximum Power at STC(W)	225W	230W	235W	240W	245W
Open Circuit Voltage(Voc/V)	37.8	38.0	38.1	38.3	38.5
Maximum Power Voltage(Vmp/V)	30.2	30.4	30.5	30.6	30.8
Short Circuit Current(Isc/A)	8.05	8.18	8.32	8.47	8.59
Maximum Power Current(Imp/A)	7.45	7.57	7.70	7.84	7.95
Power Tolerance(-/+)	-3% ~ +3%				
Nominal Operating Cell Temperature	47.0±2.0°C				
Current temperature coefficients	0.05 % /°C				
Voltage temperature coefficients	-0.35 % /°C				
Power temperature coefficients	-0.45 % /°C				
* Values at Standard Test Condition STC (Air Mass AM1.5, Irradiance 1000W/m², Cell Temperature 25°C)					

### MECHANICAL PARAMETERS

Cell(mm)	Multi 156×156
No.of cells	60 ( 6×10 )
Weight ( Kg )	19.5
Dimensions(LxWxH)(mm)	1650*992*45
Frame	Anodized aluminium alloy
Junction Box	IP65
Glass	High transmissivity, Low Iron, Tempered Glass 3.2mm
Cable	Diameter 4mm² , Length 900mm
Connector	Compatible Type IV
No.of diodes	6

### WORKING CONDITIONS

Maximum System Voltage	DC 1000V ( TUV )
Operating Temperature	( -40 ~ +85 ) °C
Maximum Series Fuse ( A )	15
Fire safety classification	Class C

### PACKAGING CONFIGURATION

Quantity/Box	24 pcs/box
Quantity/Pallet	48 pcs/pallet
Quantity/Container	672 pcs/40' HQ

### DIMENSIONS \* For other designs, please contact our sales department.

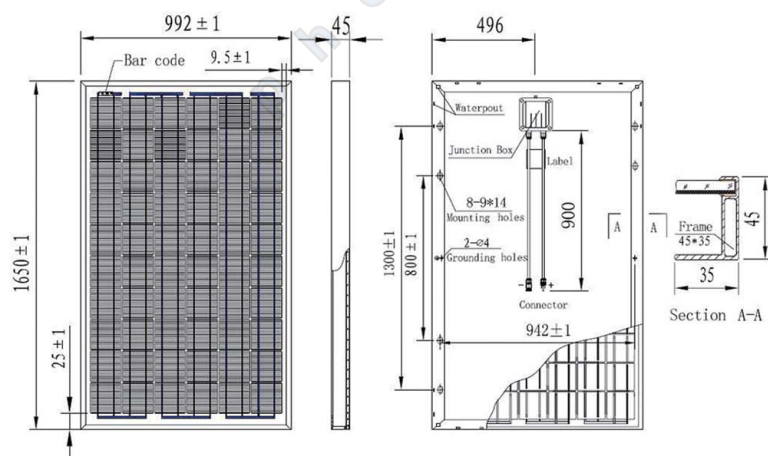

### I-V CURVES

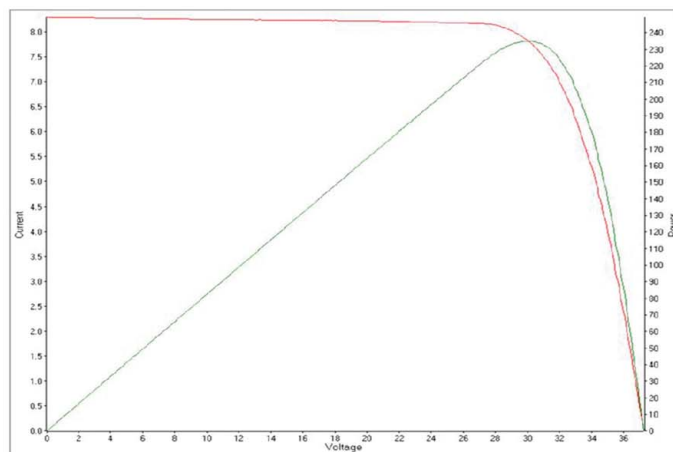

CAUTION: READ SAFETY AND INSTALLATION BEFORE USING THE PRODUCT.

January 2011 Znshinesolar Limited. All rights reserved. Specifications included in this datasheet are subject to change without notice.